

70-2115b

Seite/Page 1 / 3

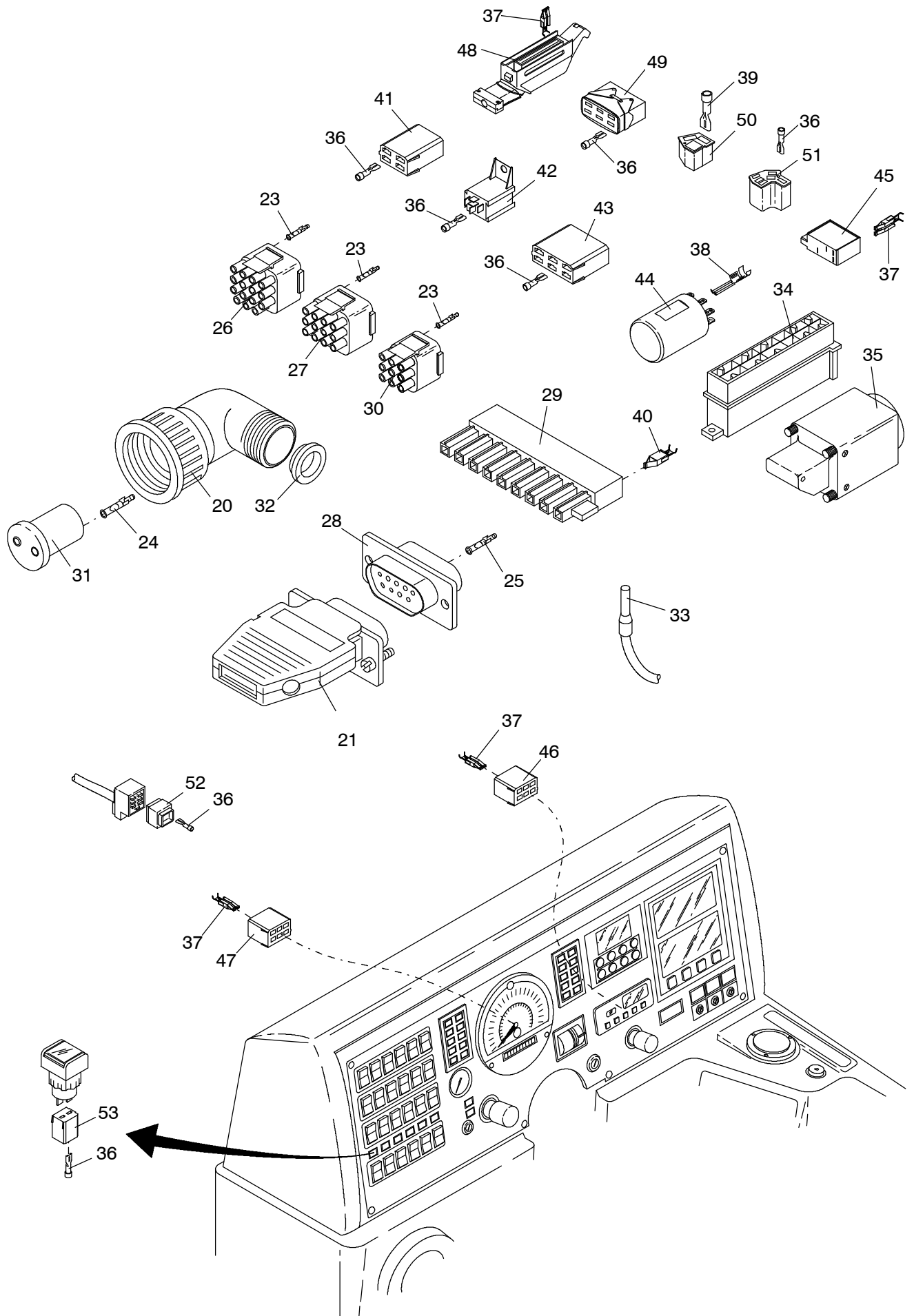

| Bild-Nr Fig Fig Fig Fig Bild nr | ET-Nr Part-No No. de Piece No. de Pieza No. del Pezzo Detalj nr | Stückzahl Qty Qte Ctd Qta Antal | | Gegenstand Description Designation Descripcion Designazione Benaemning |
|--|--|--|--|---|
| - | 671 361 40 | 1 | Zentralelektrik, kpl. | Central electric, assy. |
| 01 | 670 480 40 | 1 | Sicherungplatine F101-F128 | Fuse circuit F101-F128 |
| 02 | 509 418 98 | 9 | Flachsicherung 5 A | Fuse, 5 A |
| 03 | 509 417 98 | 11 | Flachsicherung 10 A | Fuse, 10 A |
| 04 | 509 419 98 | 5 | Flachsicherung 15 A | Fuse, 15 A |
| 05 | 509 420 98 | 4 | Flachsicherung 25 A | Fuse, 25 A |
| 06 | 461 251 40 | 2 | Impulsgeber | Sender |
| 07 | 000 402 12 | 1 | Spannungswandler | Voltage converter |
| 08 | 670 477 40 | 1 | Relaisplatine K101-K110 | Relay circuit K101-K110 |
| 09 | 515 743 40 | 10 | Relais | Relay |
| 10 | 670 471 40 | 1 | Relaisplatine K201-206 | Relay circuit K201-K206 |
| 11 | 670 472 40 | 1 | Relaisplatine K211-216 | Relay circuit K211-K216 |
| 12 | 654 751 40 | 12 | Relais | Relay |
| 13 | 670 474 40 | 1 | Diodenplatine V1-V22 | Diode circuit V1-V22 |
| 14 | 422 243 12 | 1 | Schlüsselschalter | Swicht, key operated |
| 15 | 356 265 40 | 1 | Endklammer | End clamp |
| 16 | 461 732 40 | 1 | Relaissockel | Relay base |
| 17 | 339 773 40 | 1 | Relais | Relay |
| 30 | 000 466 12 | 1 | Haltebügel zum Relaissockel | Retainer for relay base |
| 21 | 420 784 12 | - | Rundsteckhülse ø 1,52mm | Round sleeve |
| 21 | 421 245 12 | - | Rundkontaktgehäuse 9pol. | Round contact housing 9pol. |
| 21 | 420 930 12 | - | Adeckkappe für 9-polig | Cover for 9-pol. |
| 40 | - | 1 | "SPS-Komponenten" s. EL-Blatt 70-2120, etc. | "PLC components" See page 70-2120, etc. |
| | | | wahlweise | optional |
| | | | * Meterware, bei Bestellung Länge angeben | * Bulk ware, state length required |
| 41 | 513 902 98 | - | Kabel 0,5 qmm, weiß | Cable, white |
| 42 | 504 516 98 | - | Kabel 0,5 qmm, braun | Cable, brown |
| 43 | 510 112 98 | - | Kabel 1 mm ² , braun | Cable, brown |
| 44 | 510 115 98 | - | Kabel 1 mm ² , weiß | Cable, white |
| 45 | 510 114 98 | - | Kabel 2,5 mm ² , braun | Cable, brown |
| 46 | 510 117 98 | - | Kabel 2,5 mm ² , weiß | Cable, white |
| 47 | 513 903 98 | - | Kabel 4 qmm, weiß | Cable, white |
| 48 | 005 178 40 | - | Kabel 4 qmm, braun | Cable, brown |
| 51 | | - | Wellrohr | Corrugated pipe |